

# COGNITIVE INTERVIEW BOOKLET

Name (please print): \_\_\_\_\_

Today's Date: \_\_\_\_\_

**EXAMPLE OF AN INADEQUATE ANSWER**



Context: This symbol appears on machines used in the home and workplace.

What do you think this symbol means?

Gears and hand

What should you do or not do in response to this symbol?

Be careful

What could happen if you do not follow the symbol's message?

Could get hurt

**EXAMPLE OF A GOOD ANSWER**



Context: This symbol appears on machines used in the home and workplace.

What do you think this symbol means?

Caution. Moving Gears. Do not stick hand near machine while it is running.

What should you do or not do in response to this symbol?

I would stay away and not put my hand near the machine until someone stopped it.

What could happen if you do not follow the symbol's message?

My fingers or hand could be crushed by the moving gears.



This symbol might appear on certain types of furniture, such as a dresser, chest or clothing storage unit.



What do you think this symbol means?

What should you do or not do in response to this symbol?

What could happen if you do not follow the symbol's message?

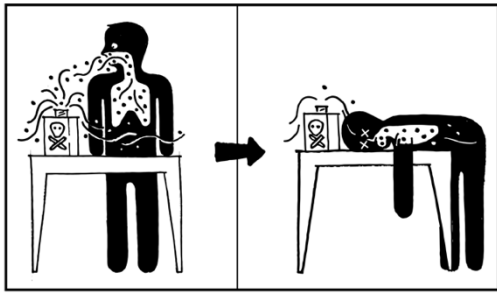

This symbol might appear on container labels of chemical solvents, such as paint strippers or paint thinners.



What do you think this symbol means?

What should you do or not do in response to this symbol?

What could happen if you do not follow the symbol's message?

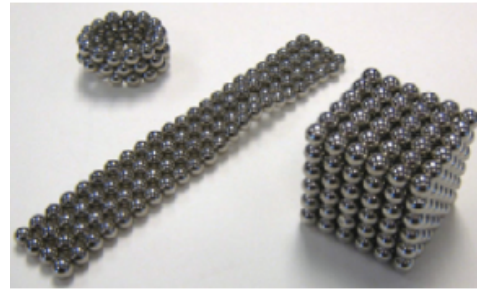
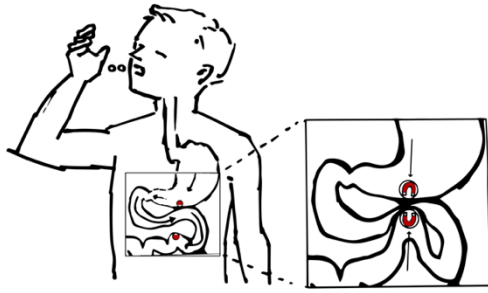

This symbol might appear on magnetic building sets or toys that contain small magnets.

What do you think this symbol means?

What should you do or not do in response to this symbol?

What could happen if you do not follow the symbol's message?

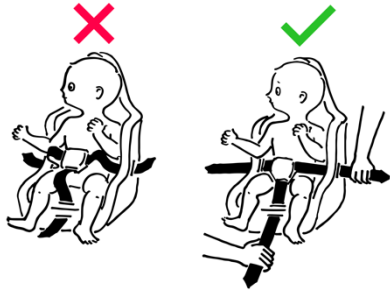

This symbol might appear on products like high chairs, infant bouncers, and other products with seating for a child.



What do you think this symbol means?

What should you do or not do in response to this symbol?

What could happen if you do not follow the symbol's message?

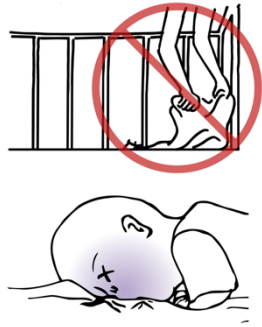

This symbol might appear on infant sleep products, such as cribs, bassinets, and play yards.

What do you think this symbol means?

What should you do or not do in response to this symbol?

What could happen if you do not follow the symbol's message?

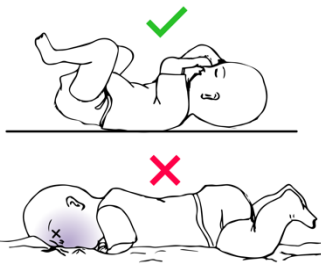

This symbol might appear on infant sleep products, such as cribs, bassinets, and play yards.

What do you think this symbol means?

What should you do or not do in response to this symbol?

What could happen if you do not follow the symbol's message?





This symbol might appear on certain types of furniture, such as a dresser, chest or clothing storage unit.



What do you think this symbol means?

What should you do or not do in response to this symbol?

What could happen if you do not follow the symbol's message?

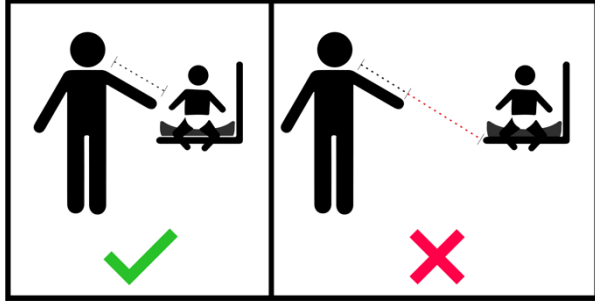

This symbol might appear on baby changing tables or changing pads.

What do you think this symbol means?

What should you do or not do in response to this symbol?

What could happen if you do not follow the symbol's message?

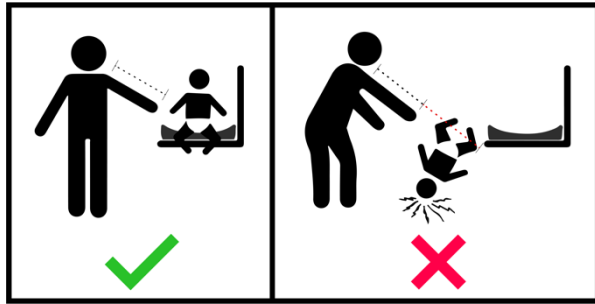

This symbol might appear on baby changing tables or changing pads.

What do you think this symbol means?

What should you do or not do in response to this symbol?

What could happen if you do not follow the symbol's message?

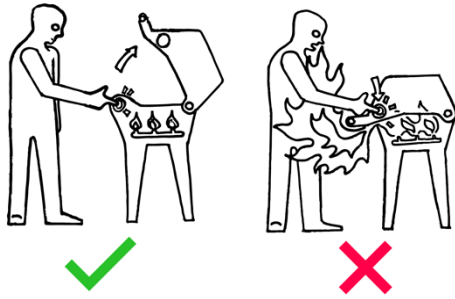

This symbol might appear on propane gas grills.



What do you think this symbol means?

What should you do or not do in response to this symbol?

What could happen if you do not follow the symbol's message?



This symbol might appear on containers of laundry detergent packets.

What do you think this symbol means?

What should you do or not do in response to this symbol?

What could happen if you do not follow the symbol's message?



This symbol might appear on certain types of furniture, such as a dresser, chest or clothing storage unit.



What do you think this symbol means?

What should you do or not do in response to this symbol?

What could happen if you do not follow the symbol's message?



This symbol might appear on baby monitors.



What do you think this symbol means?

What should you do or not do in response to this symbol?

What could happen if you do not follow the symbol's message?



This symbol appears on potentially hazardous products, such as button cell batteries.



What do you think this symbol means?

What should you do or not do in response to this symbol?

What could happen if you do not follow the symbol's message?





This symbol might appear on various children's products, such as high chairs, baby changing products, strollers, or infant swings.

What do you think this symbol means?

What should you do or not do in response to this symbol?

What could happen if you do not follow the symbol's message?



This symbol might appear on children's products, such as high chairs, infant carriers, strollers, or infant swings.



What do you think this symbol means?

What should you do or not do in response to this symbol?

What could happen if you do not follow the symbol's message?



This symbol might appear on children's toys.



What do you think this symbol means?

What should you do or not do in response to this symbol?

What could happen if you do not follow the symbol's message?

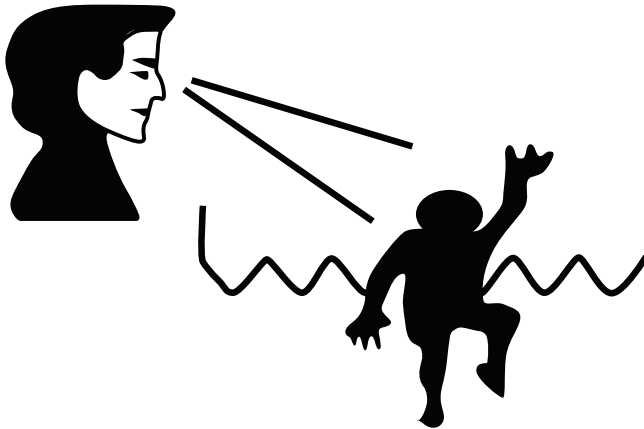

This symbol might appear on above ground residential pools or portable pools.

What do you think this symbol means?

What should you do or not do in response to this symbol?

What could happen if you do not follow the symbol's message?



This symbol might appear on or near swimming pools.



What do you think this symbol means?

What should you do or not do in response to this symbol?

What could happen if you do not follow the symbol's message?



0-36m



This symbol might appear on children's products such as infant chairs, baby bouncers, infant swings, or toys.

What do you think this symbol means?

What should you do or not do in response to this symbol?

What could happen if you do not follow the symbol's message?

Please answer the following questions about yourself:

Age: \_\_\_\_\_ Sex: \_\_\_ Male \_\_\_ Female

Education: (check the option that best describes the highest level of education you have attained)

\_\_\_ some high school \_\_\_ high school degree \_\_\_ some college

\_\_\_ 2-year college degree \_\_\_ 4-year college degree \_\_\_ master's degree

\_\_\_ doctoral

\_\_\_ other professional degree (please specify): \_\_\_\_\_

\_\_\_ other degree (please specify): \_\_\_\_\_

Marital Status:

\_\_\_ Single \_\_\_ Married \_\_\_ Legally Separated \_\_\_ Divorced

Children: \_\_\_ Yes \_\_\_ No

(if yes: please indicate the number of children that live in your home, either full-time or part-time, and their ages in the space provided):

Race:

\_\_\_ Asian \_\_\_ Black/African \_\_\_ Caucasian

\_\_\_ Hispanic/Latino \_\_\_ Native American \_\_\_ Pacific Islander

\_\_\_ Mixed Race \_\_\_ Prefer not to answer

Current occupation: \_\_\_\_\_