

Appendix A – Data collection instruments

Appendix A, Part 1: Invitation to participate in taxonomy tree test study

The following general bulletin will be issued:

Subject: 15 Minute Survey on Healthcare Terms

Dear Newsletter Recipient:

At AHRQ we are continually updating our web site to make it easier for people like you to use. We have just created a new taxonomy with the goal of making information on the site easier to find, and we'd like your help in testing it!

We'd like you to do a survey that will take approximately 15 minutes. You will be asked 12 questions such as "where would you find information about Long-term Care Facilities?" You will be presented with a list of category and subcategory names from which you can select the category and subcategory most likely to contain the information requested. When you locate the spot, you'll select the "I'd find it here" button.

All responses will be anonymous. To protect your privacy, a random number will be assigned to your survey when you go to the survey site. Your email address will not be recorded, or associated in any way with your responses.

If you have any questions or concerns please email cassandra.moore@ahrq.hhs.gov for a prompt reply.

The study will be open for only two weeks or less to hit our target of 400 respondents. We look forward to hearing what you think! Click the link below to ensure your voice is heard.

[Take me to the survey.](#)

Best regards,

The AHRQ Office of Communications and Knowledge Transfer.

Appendix A, Part 2: Sequence of Screens seen by the Participant

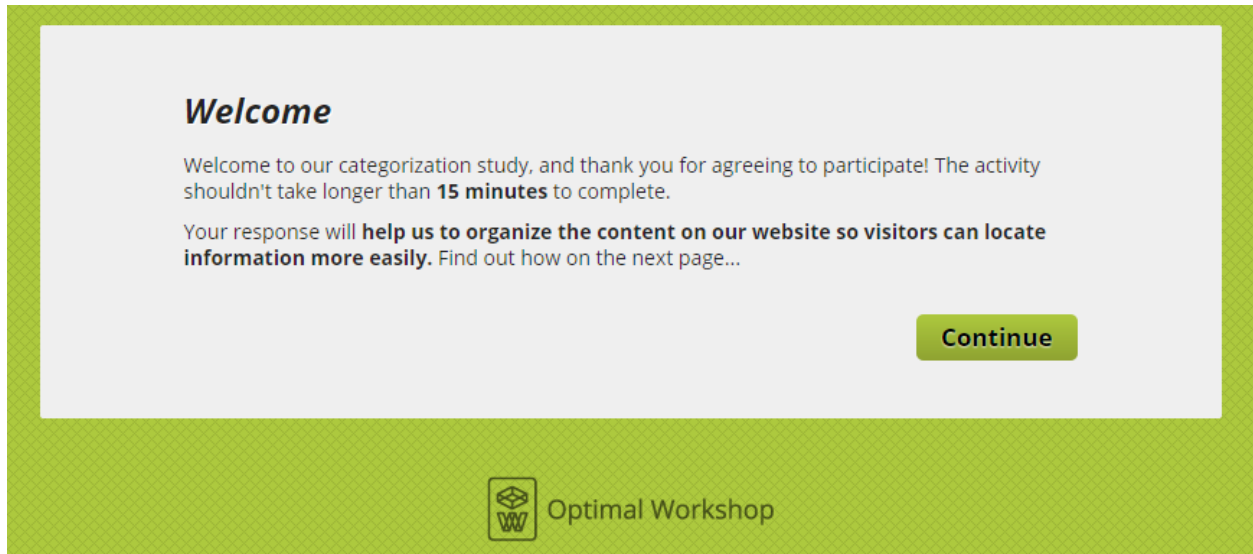

Figure 1: Page participant sees after clicking link "Take me to the survey."

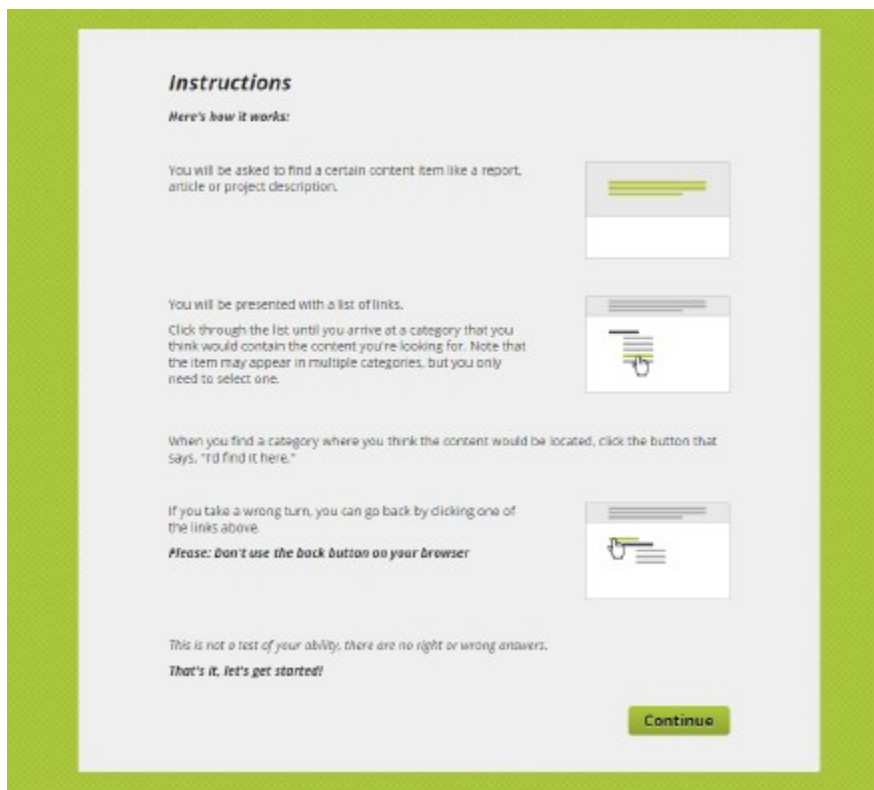

Figure 2: Page participant sees after clicking "Continue" in Figure 1.

Before we begin

Please tell us a little about yourself.

* indicates required fields

Which of the following best describes your professional affiliation? *

- Healthcare Provider
- Researcher
- Policymaker or Administrator
- Patient or Consumer
- Other

How long have you been using AHRQ.gov? *

- I haven't visited AHRQ.gov
- Less than 1 year
- 1 to 5 years
- More than 5 years

What do you typically come to AHRQ.gov to do? *

Are you an AHRQ employee? *

- Yes
- No

Are you a resident of the United States of America? *

- Yes
- No

Continue

Figure 3: Page participant sees after clicking “Continue” in Figure 2. The pre-test questions enable segmentation of audience groups for analysis of results.

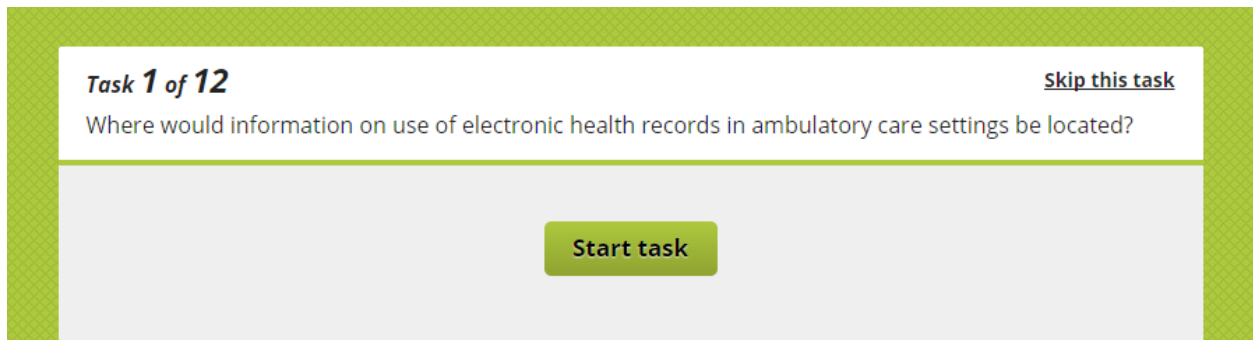

Figure 4: Page participant sees after clicking "Continue" in Figure 3. Task is described. Note that participant can elect to skip the task.

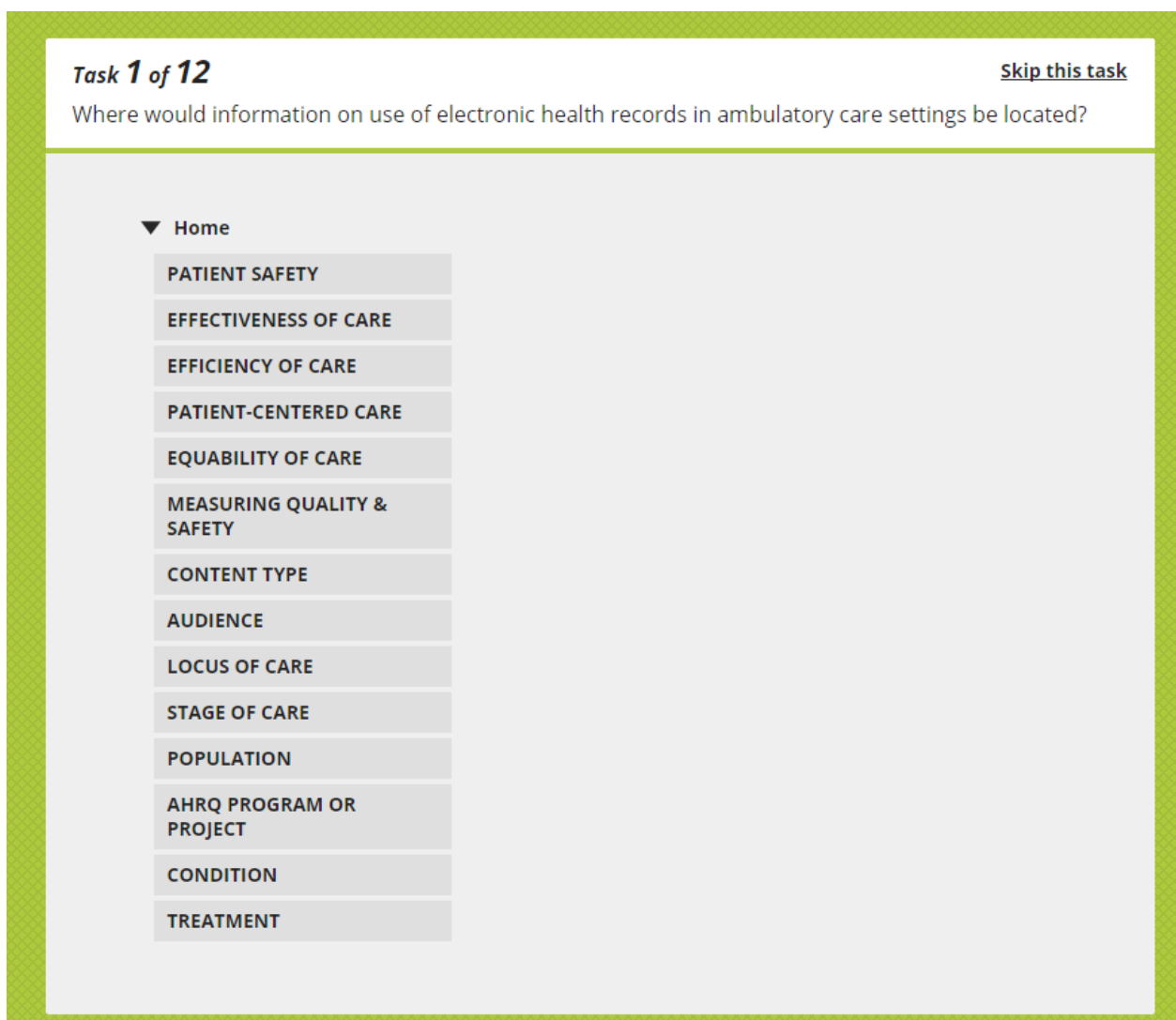

Figure 5: Page participant sees after clicking "Start Task" in Figure 4. Task description remains at the top of the page and the top level of taxonomic hierarchy is displayed. Participants select a category.

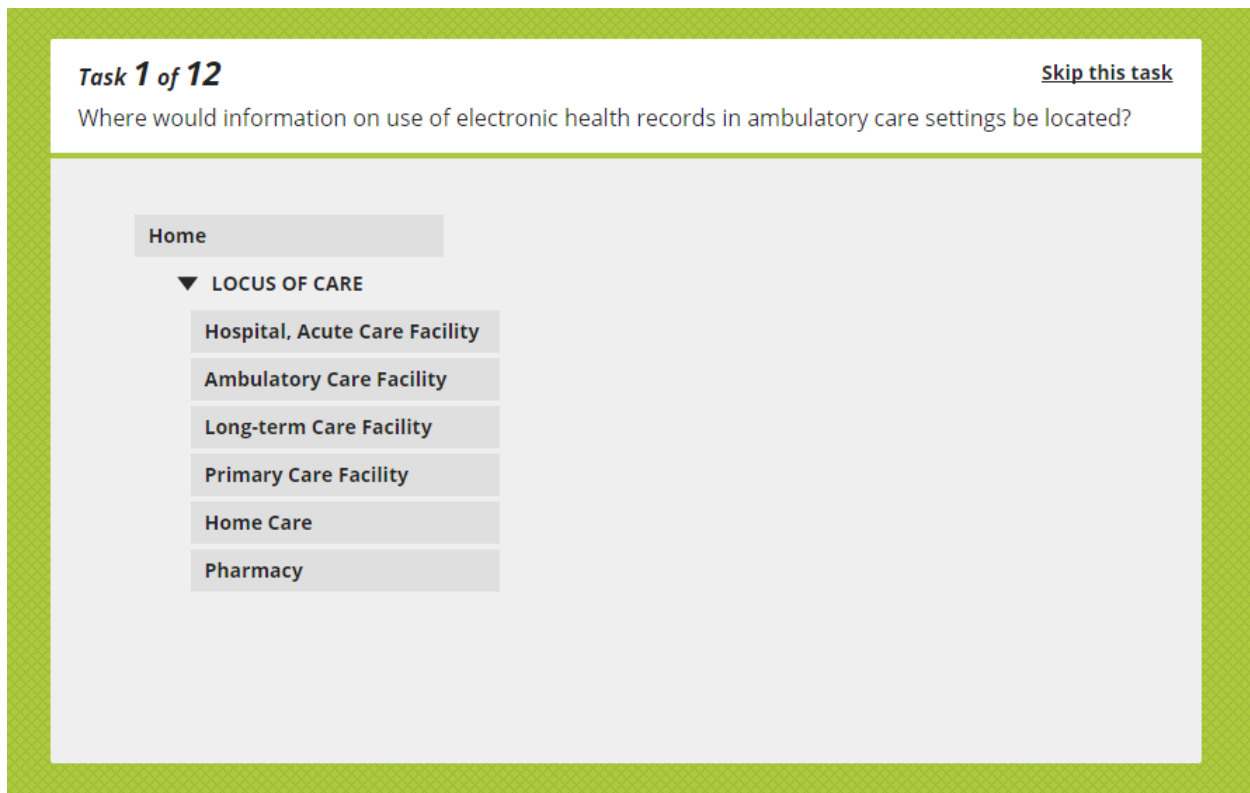

Figure 6: Page participant sees after clicking one of the categories in Figure 4. Note that the participant can go back up the hierarchy if they are not satisfied with the category they've selected. Participants select a sub-category.

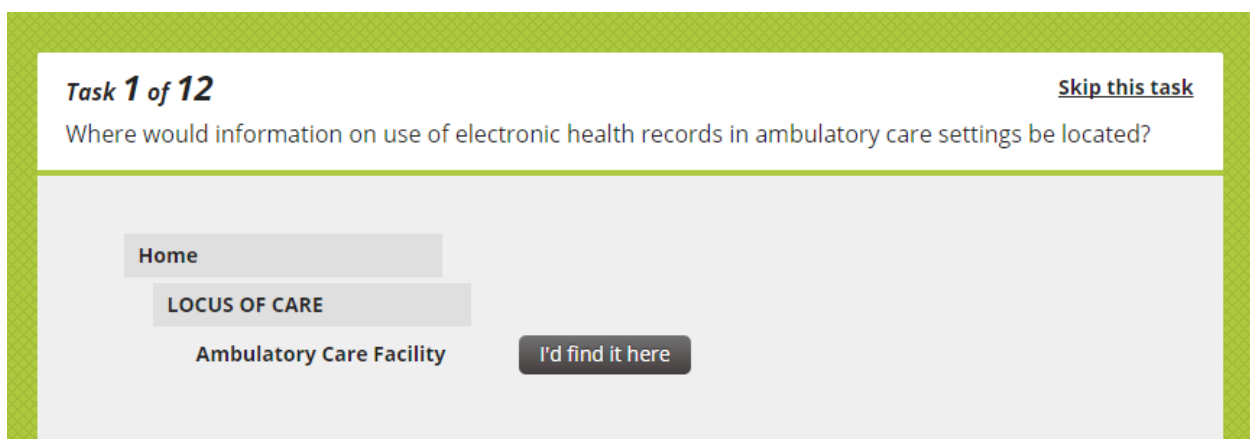

Figure 7: Page participant sees after clicking one of the sub-categories in Figure 5. Note that the participant can go back up the hierarchy if they are not satisfied with the sub-category they've selected. Clicking "I'd find it here" ends task 1 and the participant is shown task 2 which looks like Figure 4.

Appendix A, Part 3: All possible questions and correct answers

The screenshot displays the 'AHRQ Taxonomy Test' interface in the Optimal Workshop application. The top navigation bar includes the Optimal Workshop logo, 'My Account', 'Support', and 'Sean Fitzpatrick'. Below this, a secondary navigation bar shows 'Treejack', 'OptimalSort', and 'Chalkmark'. The main content area is titled 'AHRQ Taxonomy Test' and includes 'Save', 'Preview', and 'Launch' buttons. A secondary navigation bar contains 'Settings', 'Tree', 'Tasks', 'Messages', 'Questionnaire', and 'Appearance', with a 'TIPS' button on the right. The 'Tasks' section is active, showing four numbered questions. Each question has a text box for the question, a 'Correct answers' button, and a trash icon. Below each question is a list of taxonomy tags. The 'Options' section on the right includes checkboxes for 'Allow participants to skip tasks they do not wish to complete' and 'Randomize task order when presented to participants to reduce bias', and a dropdown for 'Show each participant' set to '12'.

Optimal Workshop My Account Support Sean Fitzpatrick

Treejack OptimalSort Chalkmark

AHRQ Taxonomy Test Save Preview Launch

Settings Tree **Tasks** Messages Questionnaire Appearance TIPS

Tasks Options

1 You are looking for a final report on reducing the incidence of Central Line-Associated Bloodstream Infection (CLABSI) among hospital patients. Where might you find it? Correct answers

PATIENT SAFETY > Adverse Medical Events
CONTENT TYPE > Article, Report, Publication
AUDIENCE > Healthcare Provider
LOCUS OF CARE > Hospital, Acute Care Facility

2 You would like to use the Comprehensive Unit-based Safety Program (CUSP) Toolkit to improve the way your clinical staff members work together. Where can you find it? Correct answers

PATIENT SAFETY > Culture of Patient Safety
EFFECTIVENESS OF CARE > Teamwork
CONTENT TYPE > Toolkit, Curriculum Tools
AUDIENCE > Healthcare Provider
AHRQ PROGRAM OR PROJECT > Comprehensive Unit-based Safety Program (CUSP)

3 Please locate information about the effectiveness and risks of long-term opioid treatment for chronic pain. Correct answers

EFFECTIVENESS OF CARE > Comparative Effectiveness
CONTENT TYPE > Summary, Abstract, Highlights
AUDIENCE > Healthcare Provider
STAGE OF CARE > Chronic
CONDITION > Brain, Nerve and Sensory
TREATMENT > Medications

4 You're interested in evaluating the "meaningful use" of electronic health record software. Where would you find this information? Correct answers

EFFECTIVENESS OF CARE > Technology
CONTENT TYPE > Article, Report, Publication
AUDIENCE > Researcher
AUDIENCE > Policymaker, Administrator

Options

Allow participants to skip tasks they do not wish to complete

Randomize task order when presented to participants to reduce bias

Show each participant 12 task(s)

Figure 8: Questions 1-4

5 You'd like to know the 5 most expensive healthcare conditions children can have. Where would this information be located?

Correct answers

EFFICIENCY OF CARE > Cost
 POPULATION > Children & Infants
 CONDITION > Brain, Nerve and Sensory
 CONDITION > Breathing
 CONDITION > Mental Disorders

6 Where would trends and projections in inpatient hospital utilization be found?

Correct answers

EFFICIENCY OF CARE > Utilization
 CONTENT TYPE > Statistical Brief
 AUDIENCE > Policymaker, Administrator
 LOCUS OF CARE > Hospital, Acute Care Facility

7 You want a review or meta-analysis of what works to prevent childhood obesity. Where would you look?

Correct answers

EFFECTIVENESS OF CARE > Comparative Effectiveness
 PATIENT-CENTERED CARE > Outcomes Research, PCOR
 CONTENT TYPE > Review, Synthesis
 STAGE OF CARE > Prevention, Screening
 POPULATION > Children & Infants
 CONDITION > Obesity

8 Please find information about cancer survivors' experiences interacting with health care professionals.

Correct answers

PATIENT-CENTERED CARE > Communication
 CONTENT TYPE > Statistical Brief
 CONDITION > Cancer

9 Please find information about the cost of employer-sponsored health insurance in the private sector.

Correct answers

EFFICIENCY OF CARE > Cost
 EQUABILITY OF CARE > Access to Care, Insurance
 CONTENT TYPE > Statistical Brief
 AUDIENCE > Researcher
 AUDIENCE > Policymaker, Administrator

10 Where would you find the National Healthcare Disparities Report?

Correct answers

EQUABILITY OF CARE > Disparities
 CONTENT TYPE > Article, Report, Publication
 AUDIENCE > Policymaker, Administrator
 LOCUS OF CARE > Pharmacy
 STAGE OF CARE > Primary
 POPULATION > Minorities

Figure 9: Questions 5-10

11 You would like to use the Community Pharmacy Survey on Patient Safety Culture to evaluate your pharmacy's performance. Where would you find it? Correct answers

PATIENT SAFETY > **Culture of Patient Safety**
 MEASURING QUALITY & SAFETY > **Diagnostic Tools**
 CONTENT TYPE > **Toolkit, Curriculum Tools**
 AUDIENCE > **Healthcare Provider**
 LOCUS OF CARE > **Pharmacy**
 TREATMENT > **Medications**

12 Please locate information about trends in health insurance coverage for the working poor. Correct answers

EQUABILITY OF CARE > **Access to Care, Insurance**
 POPULATION > **Low-Income**

13 Please locate information about Pediatric Quality Measures. Correct answers

MEASURING QUALITY & SAFETY > **Quality Indicators, Measures**
 AUDIENCE > **Researcher**
 AUDIENCE > **Policymaker, Administrator**
 POPULATION > **Children & Infants**
 AHRQ PROGRAM OR PROJECT > **Children's Health Insurance Program Reauthorization Act (CHIPRA)**

14 Where would you find the Guide to Clinical Preventive Services for 2014? Correct answers

CONTENT TYPE > **Article, Report, Publication**
 CONTENT TYPE > **Guidelines, Handbooks**
 AUDIENCE > **Healthcare Provider**
 LOCUS OF CARE > **Primary Care Facility**
 STAGE OF CARE > **Prevention, Screening**
 AHRQ PROGRAM OR PROJECT > **U.S. Preventive Services Task Force (USPSTF)**

15 You want guidance in improving the way health risk assessments are done in your primary care office. Where will you look? Correct answers

PATIENT-CENTERED CARE > **Communication**
 MEASURING QUALITY & SAFETY > **Diagnostic Tools**
 AUDIENCE > **Healthcare Provider**
 STAGE OF CARE > **Primary**

16 Please locate information on building quality improvement capacity in primary care practices. Correct answers

CONTENT TYPE > **Article, Report, Publication**
 AUDIENCE > **Healthcare Provider**
 LOCUS OF CARE > **Primary Care Facility**
 STAGE OF CARE > **Primary**

Figure 10: Questions 11-16

17 Please find information about the Children's Health Insurance Program Reauthorization Act (CHIPRA). Correct answers

EQUABILITY OF CARE > Access to Care, Insurance
 MEASURING QUALITY & SAFETY > Quality Indicators, Measures
 CONTENT TYPE > Article, Report, Publication
 AUDIENCE > Healthcare Provider
 AUDIENCE > Researcher
 AUDIENCE > Policymaker, Administrator
 POPULATION > Children & Infants
 AHRQ PROGRAM OR PROJECT > Children's Health Insurance Program Reauthorization Act (CHIPRA)

18 AHRQ has funded research on care of people with Multiple Chronic Conditions (MCC). Please find it. Correct answers

LOCUS OF CARE > Long-term Care Facility
 STAGE OF CARE > Chronic
 CONDITION > Breathing
 CONDITION > Cancer
 CONDITION > Diabetes

19 Where would you find information about a Patient-Centered Medical Home? Correct answers

PATIENT-CENTERED CARE > Medical Home, PCMH
 CONTENT TYPE > Article, Report, Publication
 AUDIENCE > Healthcare Provider
 LOCUS OF CARE > Primary Care Facility
 STAGE OF CARE > Primary

20 Where would information on use of electronic health records in ambulatory care settings be located? Correct answers

EFFECTIVENESS OF CARE > Technology
 AUDIENCE > Healthcare Provider
 AUDIENCE > Researcher
 AUDIENCE > Policymaker, Administrator
 LOCUS OF CARE > Ambulatory Care Facility

21 You're interested in the success rates of different therapies for children with autism spectrum disorder. Where would you find that information? Correct answers

EFFECTIVENESS OF CARE > Comparative Effectiveness
 AUDIENCE > Healthcare Provider
 AUDIENCE > Researcher
 POPULATION > Children & Infants
 CONDITION > Behavior
 CONDITION > Brain, Nerve and Sensory
 CONDITION > Mental Disorders

Figure 11: Questions 17-21

22

Where would information about the National Guideline Clearinghouse be found?

Correct answers
☰

CONTENT TYPE > **Guidelines, Handbooks**
 AUDIENCE > **Healthcare Provider**
 AUDIENCE > **Researcher**
 LOCUS OF CARE > **Hospital, Acute Care Facility**
 LOCUS OF CARE > **Ambulatory Care Facility**
 LOCUS OF CARE > **Long-term Care Facility**
 LOCUS OF CARE > **Primary Care Facility**
 STAGE OF CARE > **Prevention, Screening**
 STAGE OF CARE > **Primary**
 AHRQ PROGRAM OR PROJECT > **National Guideline Clearinghouse (NGC)**
 TREATMENT > **Medications**

23

You are looking for a statistical brief called "National Inpatient Hospital Costs: The Most Expensive Conditions by Payer". Where might you find it?

Correct answers
☰

EFFICIENCY OF CARE > **Cost**
 CONTENT TYPE > **Statistical Brief**
 AUDIENCE > **Researcher**
 AUDIENCE > **Policymaker, Administrator**
 LOCUS OF CARE > **Hospital, Acute Care Facility**
 STAGE OF CARE > **Acute Care**
 CONDITION > **Breathing**
 CONDITION > **Cancer**
 CONDITION > **Heart and Blood Vessel**
 CONDITION > **Infectious Disease**
 CONDITION > **Muscle, Bone and Joints**

24

Please find the National Healthcare Quality Report, Chapter 10, Access to Healthcare.

Correct answers
☰

EQUABILITY OF CARE > **Access to Care, Insurance**
 MEASURING QUALITY & SAFETY > **National Healthcare Quality Report**
 CONTENT TYPE > **Article, Report, Publication**
 AUDIENCE > **Researcher**
 AUDIENCE > **Policymaker, Administrator**

+ Add task

[Services](#)
[Support](#)
[Blog](#)
[Twitter](#)
[Facebook](#)

Use of Optimal Workshop signifies agreement with our [Privacy Policy](#) and [Terms of Service](#).

© 2014 Optimal Product Ltd trading as Optimal Workshop. All rights reserved.

?

Figure 12: Questions 22-24

Appendix A, Part 4: Post-study questions and thank you

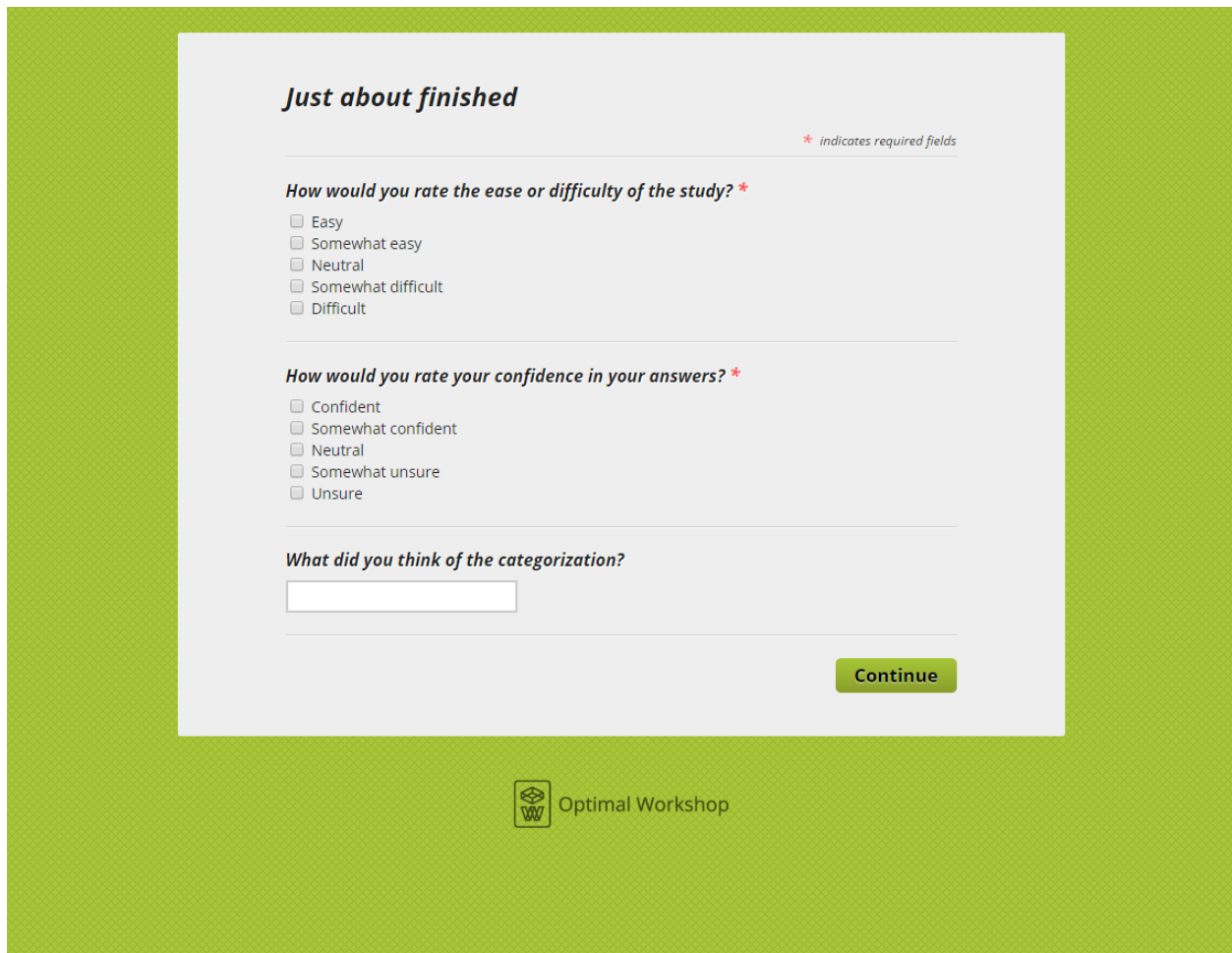

Just about finished

* indicates required fields

How would you rate the ease or difficulty of the study? *

- Easy
- Somewhat easy
- Neutral
- Somewhat difficult
- Difficult

How would you rate your confidence in your answers? *

- Confident
- Somewhat confident
- Neutral
- Somewhat unsure
- Unsure

What did you think of the categorization?

Continue

 Optimal Workshop

Figure 13: Screen seen by participant after having viewed 12 of the 24 possible questions.



Thanks

All done, awesome! Thanks again for your participation. Your feedback is incredibly useful in helping to determine how our content should be organized so it's easier to find.

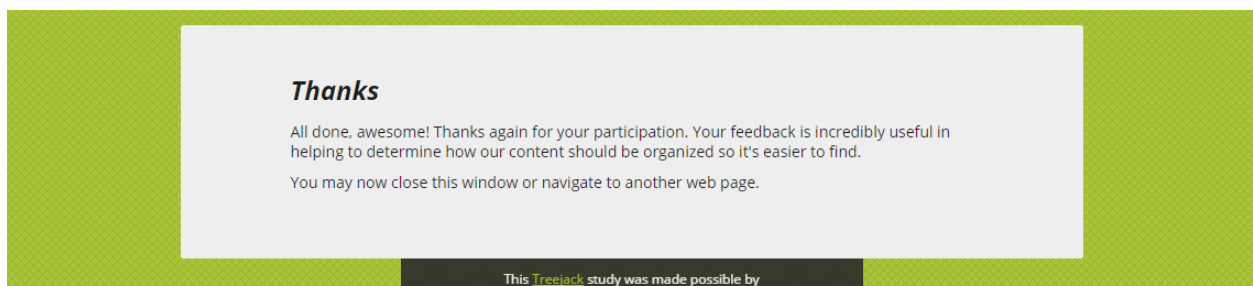
You may now close this window or navigate to another web page.

This Treejack study was made possible by

Figure 14: Screen seen by participant after clicking “Continue” in Figure 13.